

FIELD CUT SIDES OF BATTEN CAP. NOTCH BOTTOM LEGS OF UPPER PORTION OF BATTEN CAP AS REQUIRED (VARIES PER ROOF SLOPE). BEND LOWER PORTION OF BATTEN CAP INTO PLACE. FASTEN IN PLACE WITH 1/8" RIVETS, BOTH SIDES.

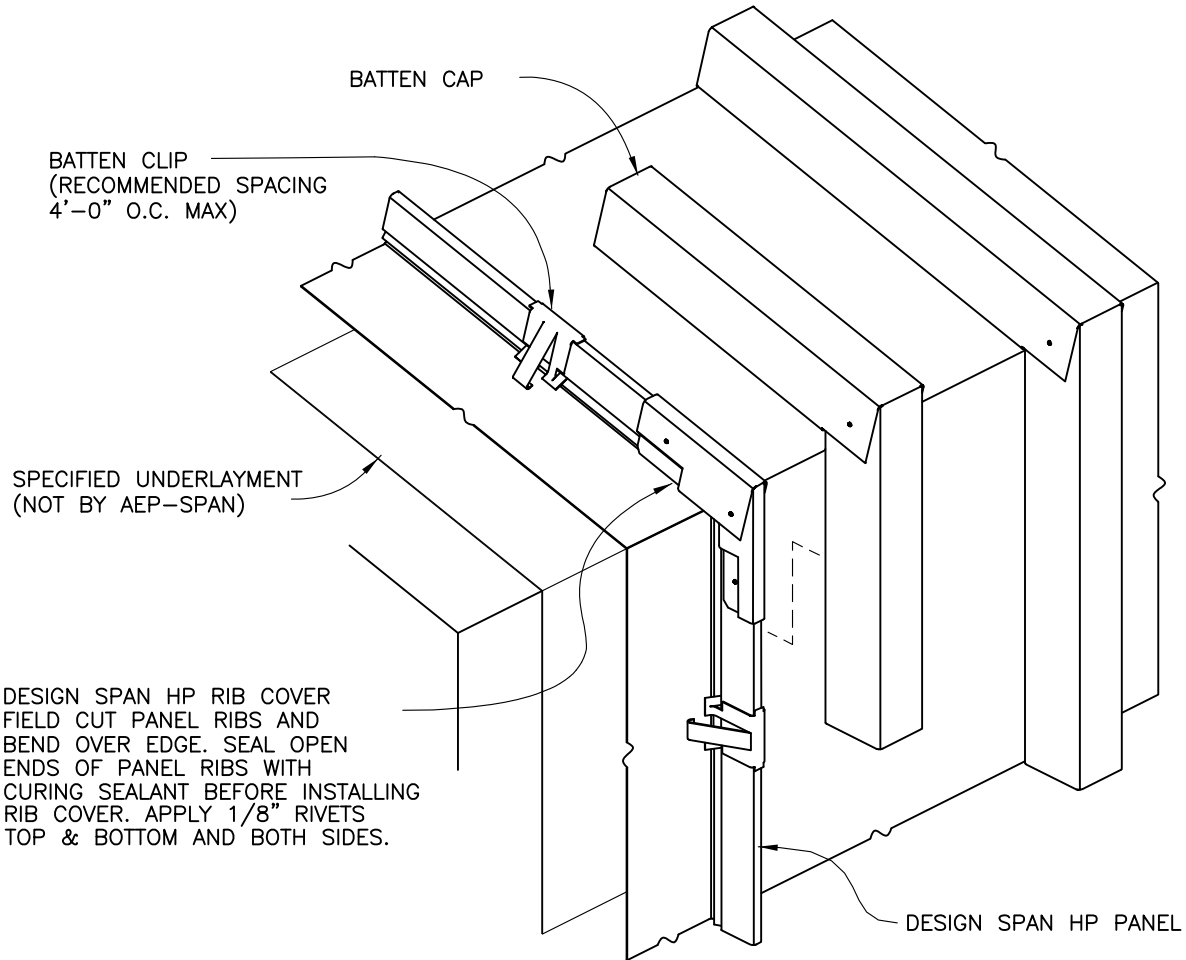

**DESIGN CAUTION:**  
ROOF SLOPE TRANSITIONS SUCH AS FASCIAS MAY ESTABLISH AN UNWANTED POINT OF PANEL FIXITY. CONTACT YOUR AEP SPAN REPRESENTATIVE FOR ASSISTANCE.

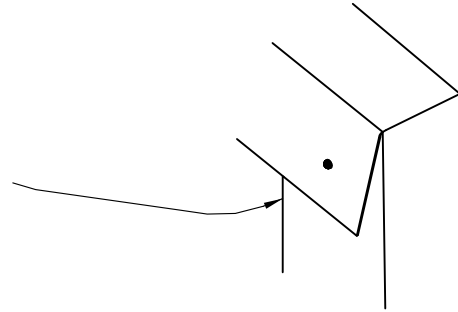

DESIGN SPAN HP



FASCIA TRANSITION  
(WIDE BATTEN)

DS-09